

Recyclable if sorted
by type of garbage
Non-recyclable trash
if disposed altogether



How to correctly separate garbage and recyclable items

Fiscal
2026

Please keep this in easy to reference location Please check the pamphlets for the proper way to dispose of garbage and recyclable materials

Burnable garbage

Twice a week
Designated pickup point in your district



Please put the garbage into the designated bags which have certified stamps

- Plastic products
- Papers (Non-recyclable items)
- Disposable diapers
- Small wooden goods, wooden boxes
- Ski or snowboard boots
- Clothing, cloth
- Kitchen garbage
- Extras
- Tie in bundles and put a garbage sticker.
- Bedclothes, carpets, mattress
- Boards, garden shrubs

Disposable plastic containers

Once a week
Designated pickup point in your district



Please put garbage into the designated bags

- Plastic containers and packaging carrying this mark are the subject. Please clean
- Packages with unremovable residue are Burnables
- Bottles
- Net
- Tray
- White foam trays are "Other Recyclables"
- Caps, pacs
- Caps
- Grocery bags
- Styrenefoam sport packaging

Metal utensils

Twice a month
Designated pickup point in your district



Please put garbage into designated bags

- Small home appliance
- Batteries are "harmful wastes (Recyclable items)"
- Aluminum cans
- Steel cans
- Spray cans
- Kitchen goods
- Kettles, pots
- Umbrellas
- Knives, kitchen knives
- Electric blanket
- Electric heated carpets

The other recyclable materials

Once a month Community centers, etc. in your district

PET bottle

- Pay attention to the mark
- Remove caps and labels
- Rinse with water
- Crush as much as possible
- Put in the mesh bags at your designated pick-up point.

Caps and labels are recyclable plastics



Let's use the supermarket disposal sites

Lightly coloured styrenefoam trays

Non-foam regular plastic trays and colored foam trays are "Plastic Packagings". Natto containers are "Burnables".

- Please put it in the bag at the disposal site



Let's use the supermarket disposal sites

Old paper

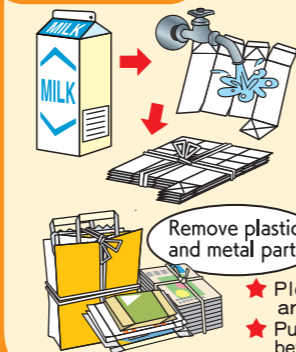

Drink cartons

Burnable if inside is lined with foil

- Cut open, wash and dry
- Please put them in the net bags at the disposal site

Magazines, paper

Magazines, books, leaflets, poster boards, wrapping paper, printer paper, paper boxes

- Paper with leftover smell, pressure seal forms, photos, waterproof paper and receipts are "Burnables".
- Please make large bundles of similar size and wrap with string in a cross
- Put small pieces of paper in a paper bag before tying.

News papers

Crosstie with a string.

Cardboard

Cardboards with corrugated paper inside only.

- Tie in bundles with a string or packaging tape.

Bottles

Glass, heatproof glass and cracked items are "landfill waste".



- Caps can be either plastic or burnable garbage
- Plastic label to be removed and handled as "plastic garbage". (Paper label need not be removed.)
- Pop can tabs depend of the metal

Please clean Sort them by colour Sort bottles by color even when broken

Return them to the point of purchase

Beer, sake, milk, and soft drink bottles (Returnable glass bottles)

Please check with the shop where they were purchased for information on how to recycle these returnables.

Oversized garbage

Burnable garbage

- Wooden furniture, tatami mats, etc.
- Occasional large quantities of garbage, such as when moving
- Large amount of garden trees
- No construction waste or untreatable waste.

If you are bringing in wood or carpet that needs to be crushed, please make sure it is no longer than 2m50cm in length.

Carry in to Higashiyama Clean Center.

Open Hours

From Monday to Friday AM8:30~PM4:30 (Until 3:00pm things that require breaking)
Saturday AM8:30~PM0:00 (-11:00am if your waste needs crushing.)
Except holidays and 12/30~1/3.

Non-burnable (Metallic) garbage

- Home appliances (Except TV, refrigerator, computer, etc.)
- Baby buggy, car seat
- Bicycle, steel desk, skis, other metal products

Apply and carry in to:

Tel. 22-7074



Landfill garbage

Once a month
Designated pickup point in your district



Please put the garbage into the designated bags which have certified stamps

- Japanese tea cups and stone bowls
- Hazardous materials (Needles, lighters, etc.)
- PVC pipes and boards
- Glasses and glass plates
- Glass
- Clay pots
- Vases
- Ashes from cooking and heating

Hazardous Waste (Recyclable)

Twice a year
You have an assigned disposal site. Conducted on the cleaning day of whole city

- Used batteries
- Button cell batteries
- Rechargeable batteries
- Small appliances with non-removable rechargeable batteries
- Flourent bulbs
- Glow lamp
- Light bulb
- Liquid based thermometers
- Mirrors

Recyclable items collected on Sundays

Once a month (Closed from December to February.)
The parking lots of supermarkets in the city.

- PET bottles/Bottles/Old paper
- Hard plastic products
- Old clothes
- Used cooking oil

Recyclable items collected on the designated dates

- Used tires
- Pottery and porcelain

Items the city collection system cannot handle

Please consult with the item dealer or a waste disposal company.

- Paint, chemicals, etc.
- Used oil
- Bathtubs
- Items belonging to Industrial Waste
- Home medical waste including syringes and needles, etc.
- Gas canisters
- Containers for agricultural chemicals, powerful medicines or poisons, or pesticides
- Couches
- Pianos, organs
- Spring mattresses
- Automobiles
- High-pressure gas containers, etc.
- Agricultural machines and tools

Cellular phones

Cellular phones contain precious metals. Please return your unused cellular phones to the place of purchase.

Fire extinguishers

Contact Fire Extinguisher Recycling Promotion Center for information about recycling a fire extinguisher. TEL 03-5829-6773

You are required by law to return the following electrical appliances to their maker for proper recycling.

- Air conditioners
- Refrigerators, Freezers
- Washing machines
- Televisions
- Clothes dryer

Either return these items to the place where they were purchased, or when buying a new one, have the shop take the old one when the new one is delivered.

Computers
These items should be returned to their maker for proper disposal. <http://www.pc3r.jp/>

